

Product Data Sheet

Elastodrain® EL 202

Order No. 3220

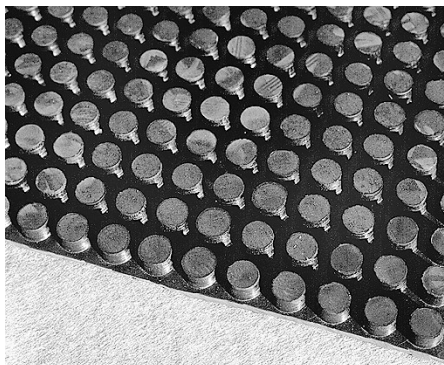

Protection and drainage sheet with extremely high loadability; designed for use under driveways, access roads for fire brigades, parking areas, etc.



The EL 202-panels can be fixed with detachable connectors.

Technical Data

Elastodrain® EL 202

Compression moulded building protection and drainage sheet of solid, vulcanized rubber, with a rebated edge and one-sided stud structure. The boards can be inter-connected with special EL 202-Connectors.

Colour:	black
Height:	ca. 19 mm
Stud height:	ca. 12 mm
Number of studs:	ca. 1200 /m ²
Weight:	ca. 19 kg/m ²

Compressive strength

at 10% compression:

Shore-strength:

Static foundation support module:

Heat resistance:

ca. 400 kN/m²

ca. 75 Shore A

ca. 285 MN/m³

up to 200° C, briefly up to > 250° C

In-plane water flow capacity (EN ISO 12958):

roof slope 1%:

ca. 0.34 l/(s·m)

roof slope 2%:

ca. 0.47 l/(s·m)

roof slope 3%:

ca. 0.57 l/(s·m)

Dimensions:

ca. 1.00 m x 1.00 m

Accessories:

Rubber 2-hole Connector

Order No. 3221

Features

- extremely high mechanical loadability
- step joint edging
- protection layer according to German Standard DIN 18 195
- drainage effect according to German Standard DIN 4095
- "spade resistant"
- reduces subsonic noise
- high stability even during storms
- quick and easy installation
- joint connector as accessory available

Application Example

"Driveway for Cars"

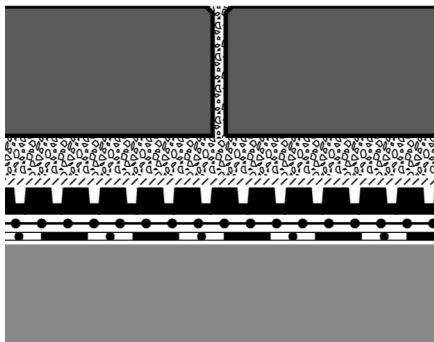

Slabs in chipping bedding

Filter Sheet TG

Elastodrain® EL 202

Slip Sheet TGF 20, 2-layers

Roof construction with root resistant waterproofing

Specification Suggestion

Trafficable protection and drainage sheet of solid, vulcanized rubber, with a step joint edging and a one-sided stud structure, weight ca. 19 kg/m², stud height ca. 12 mm, total height ca. 19 mm, Shore-strength 75 Shore A, static foundation support module ca. 285 MN/m³, in-plane water flow capacity tested

according to EN ISO 12958, delivery and installation to manufacturer's instructions, to be fixed with two detachable connectors per meter.

Make: ZinCo Elastodrain® EL 202
Enquiries: ZinCo Green Roof Systems Ltd.
Phone: +44 (0)1993 229 700

ZinCo Green Roof Systems Ltd.

Wittas House · 2 Rivers Industrial Estate · Station Lane · Witney OX28 4BH · United Kingdom

Phone +44 (0)1993 229700 · Fax +44 (0) 2031 631915

office@zinco-greenroof.co.uk · www.zinco-greenroof.co.uk

Life on Roofs

