

Project Report

Pakhuis Australië, Amsterdam



The inner courtyard of the "Australiëgebouw" with Pitched and Flat Green Roof.

Project Data

Area: ca. 550 m²

Construction Year: 2005

Architect/Design:
DKV architects, Rotterdam

Contractor:
Roosendaal landscaping

Note:
In sub area, roof slope from about 30°

Coordinates:
52°22'33.84"N 4°55'34.86"E

Conception

This green roof project was part of a renovation of the 19th century warehouses located on the waterfront of "Het IJ" in Amsterdam. The old warehouse "Australië" was integrated into a new residential building and on a portion of this new building the green roof was created.

The green roof includes a flat section with trees and lawn and is located approximately 5 meters above ground level. It should be created a connection through

a sloped roof surface, which was also to be planted with grass. Installing lawn on the steep area was a challenge since a supply of nutrients and water must be ensured.

Therefore, two layers of Georaster® were installed to accommodate more substrate. Later after maintaining the lawn on the steep pitched area turned out to be too costly the lawn was exchanged by a low maintenance ground cover planting.



View from the Java island to the former warehouse.

System Build-up

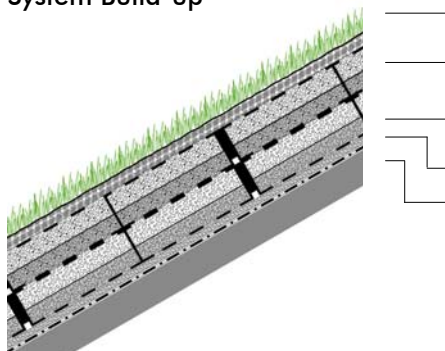

- Plant layer
- 2. Layer Georaster® - infilled with System Substrate "Lawn"
- 1. Layer Georaster® - infilled with Mineral Substrat
- Protection Mat WSM 150
- Roof construction with root resistant waterproofing



The maintenance of the lawn turned out to be costly. Therefore it was exchanged by a low maintenance ground cover planting.



The proposed turf was intended to invisibly connect the pitched roof area to the flat roof area.



Two layers of Georaster® filled with substrate ensure proper supply of water and nutrients for the lawn.



The pitched roof shortly after installation of the turf. Skylights allow for natural daylight inside the building.

ZinCo Green Roof Systems Ltd.

St. John's Innovation Centre · Cowley Road · Cambridge CB4 0WS · Great Britain
Phone +44 (0)1223 853843 · Fax +44 (0) 2031 631915
office@zinco-greenroof.co.uk · www.zinco-greenroof.co.uk



Life on Roofs